

with SLS 18



SERVOS

Controlable elements	Quantity	Type of servo
Elevator	1	HS-5645 MG digi
Rudder	1	HS-645 MG
Ailerons	2	HS-5125 MG digi
Flaps	2	HS-5125 MG digi
Airbrakes	2	HS-125 MG
Landing gear	1	HS 7955 TG
Brake of landing gear	1	HS-311
Tow hook	1	HS-645 MG
SLS 18	1	HS 7955 TG
Water ballast*	2	SS 1816

* if installed

Technical informations

Scale	1:3,75
Span	4,8 m / 5,33 m
Lenght	2,29 m
Profil	HQ 3,0 (wood wings) HQ 2,5 (moulded wings)
Load	107 /98 g/dm ²
Central of gravity	72 mm from LE
Elevator	+15/-15 mm
Rudder	L / R 70mm
Ailerons	+15/-10 mm
Flaps	+3/-4 mm

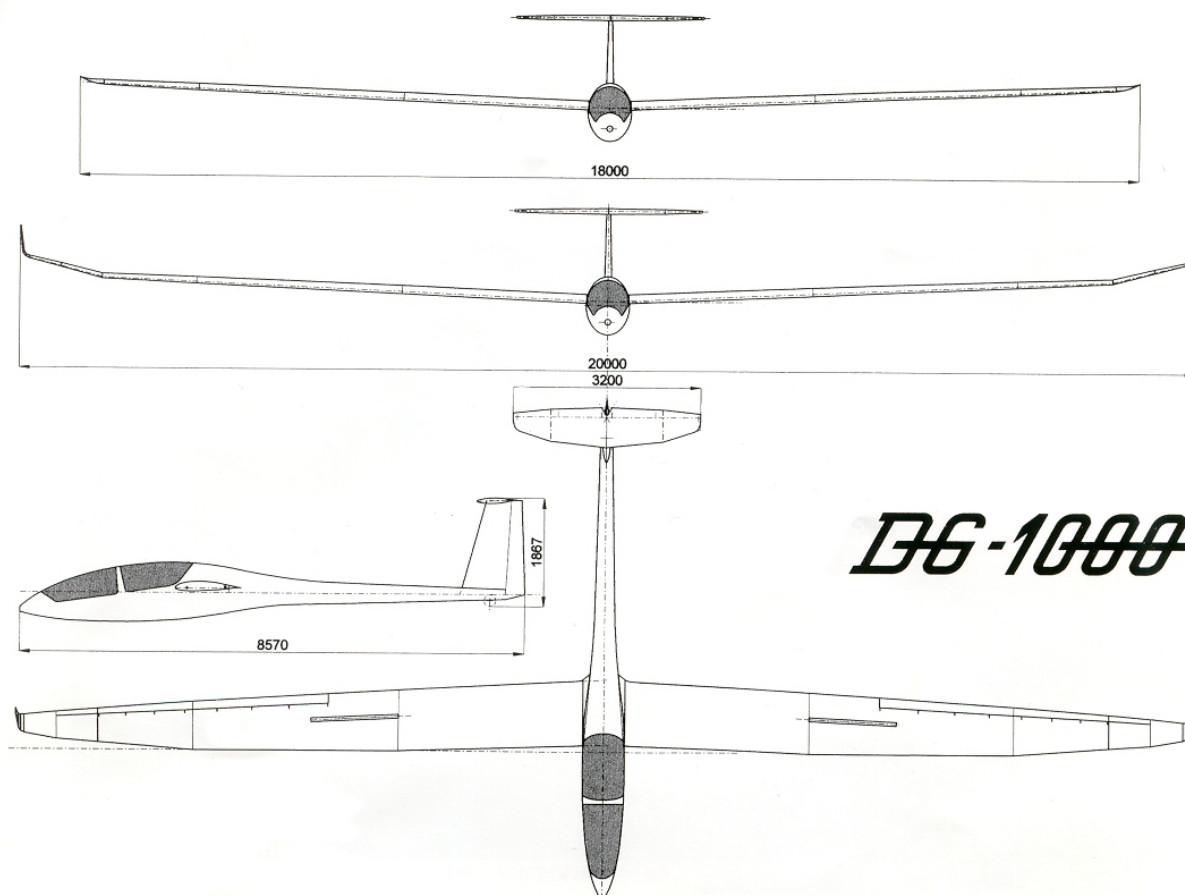

ANNOUNCED SPECIFICATION OF HS-5645MG STANDARD SPORT DIGITAL HIGH TORQUE SERVO

1. TECHNICAL VALUES

CONTROL SYSTEM	:+PULSE WIDTH CONTROL 1500usec NEUTRAL	
OPERATING VOLTAGE RANGE	:4.8V TO 6.0V	
OPERATING TEMPERATURE RANGE	:-20 TO +60° C	
TEST VOLTAGE	:AT 4.8V	:AT 6.0V
OPERATING SPEED	:0.23sec/60° AT NO LOAD	:0.18sec/60° AT NO LOAD
STALL TORQUE	:10.3kg.cm(143.03oz.in)	:12.1kg.cm(168.03oz.in)
OPERATING ANGLE	:45°/ONE SIDE PULSE TRAVELING 400usec	
DIRECTION	:CLOCK WISE/PULSE TRAVELING 1500 TO 1900usec	
IDLE CURRENT	:3mA	:3mA
RUNNING CURRENT	:350mA	:450mA
DEAD BAND WIDTH	:1usec	
CONNECTOR WIRE LENGTH	:300mm(11.81in)	
DIMENSIONS	:40.6x19.8x37.8mm(1.59x0.77x1.48in)	
WEIGHT	:60g(2.11oz)	

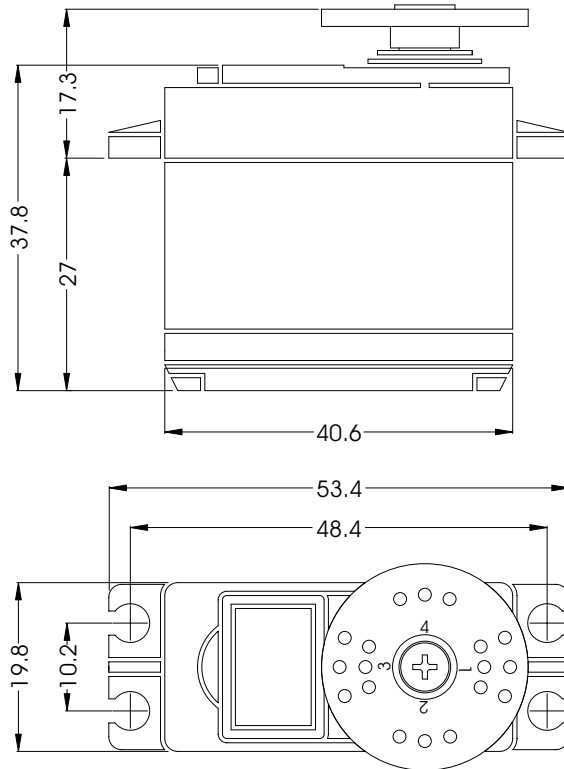

2. FEATURES

- DIGITAL & MOS FET AMP
- PROGRAMABLE
- 3-POLE FERRITE MOTOR
- DUAL BALL BEARING
- 3-METAL GEARS
- LONG LIFE POTENTIOMETER

3. APPLICATIONS

- AIRCRAFT TO 1/4 SCALE
- 30 TO 60 SIZE HELICOPTERS
- STEERING AND THROTTLE FOR 1/10TH & 1/8TH ON-ROAD AND OFF-ROAD VEHICLES

ANNOUNCED SPECIFICATION OF HS-5125MG SLIM DIGITAL SERVO

1. TECHNICAL VALUES

CONTROL SYSTEM	: +PULSE WIDTH CONTROL 1500usec NEUTRAL	
OPERATING VOLTAGE RANGE	: 4.8V TO +6.0V	
OPERATING TEMPERATURE RANGE	: -20° C TO +60° C	
TEST VOLTAGE	: AT 4.8V	AT 6.0V
OPERATING SPEED	: 0.17sec/60° AT NO LOAD	0.13sec/60° AT NO LOAD
OPERATING TORQUE	: 3kg.cm(41.66oz.in)	3.5kg.cm(48.60 oz.in)
STANDING TORQUE	: 6kg.cm(83.32oz.in)	7kg.cm(97.21 oz.in)
OPERATING ANGLE	: 40°/ONE SIDE PULSE TRAVELING 400usec	
DIRECTION	: CLOCK WISE/PULSE TRAVELING 1500 TO 1900usec	
IDLE CURRENT	: 3mA	3mA
RUNNING CURRENT	: 180mA	230mA
DEAD BAND WIDTH	: 1usec	
CONNECTOR WIRE LENGTH	: 300mm(11.81in)	
DIMENSIONS	: 30x10x34mm(1.18x0.39x1.33in)	
WEIGHT	: 24g(0.84oz)	

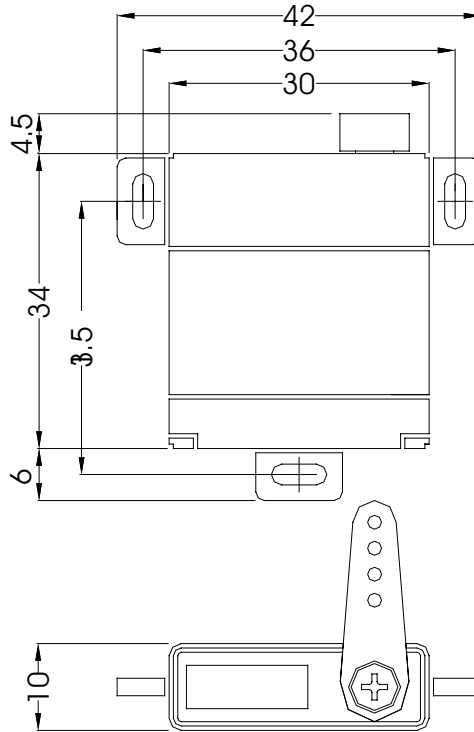

2. FEATURES

- DIGITAL & MOS FET AMP
- PROGRAMBLE
- 3-POLE FERRITE MOTOR
- LONG LIFE POTENTIOMETER
- NARROW DEAD BAND WIDTH AND HIGH STANDING TORQUE
- GOLD PLATED CONTACTS
- DUAL BALL BEARING
- 4 METAL GEAR & METAL RESIN GEAR
- METAL SPLINED HORN

3. APPLICATIONS

- GLIDER WINGS



ANNOUNCED SPECIFICATION OF HS-645MG STANDARD DELUXE HIGH TORQUE SERVO

1. TECHNICAL VALUES

CONTROL SYSTEM	: +PULSE WIDTH CONTROL 1500usec NEUTRAL	
OPERATING VOLTAGE RANGE	: 4.8V TO 6.0V	
OPERATING TEMPERATURE RANGE	: -20 TO +60° C	
TEST VOLTAGE	: AT 4.8V	: AT 6.0V
OPERATING SPEED	: 0.24sec/60° AT NO LOAD	: 0.2sec/60° AT NO LOAD
STALL TORQUE	: 7.7kg.cm(106.93oz.in)	: 9.6kg.cm(133.31oz.in)
OPERATING ANGLE	: 45°/ONE SIDE PULSE TRAVELING 400usec	
DIRECTION	: CLOCK WISE/PULSE TRAVELING 1500 TO 1900usec	
IDLE CURRENT	: 8.8mA	: 9.1mA
RUNNING CURRENT	: 350mA	: 450mA
DEAD BAND WIDTH	: 8usec	
CONNECTOR WIRE LENGTH	: 300mm(11.81in)	
DIMENSIONS	: 40.6x19.8x37.8mm(1.59x0.77x1.48in)	
WEIGHT	: 55.2g(1.94oz)	

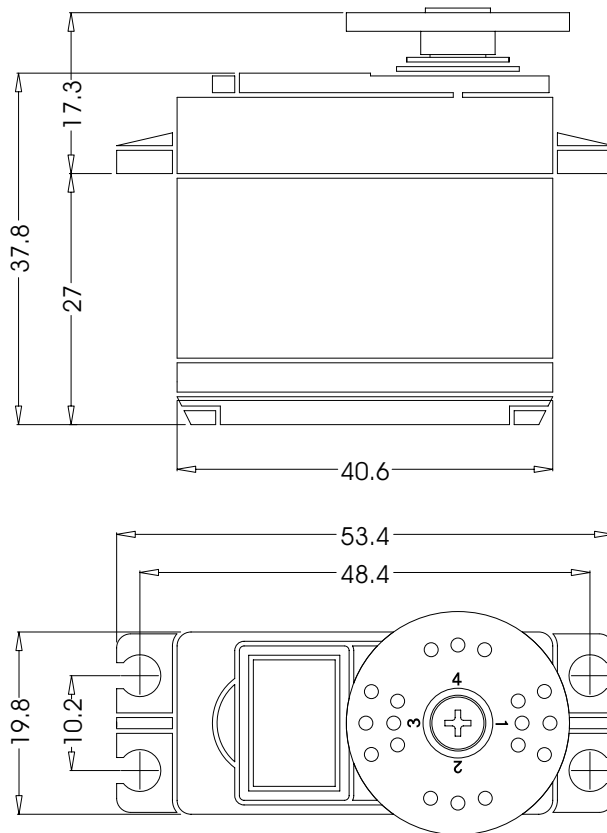

2. FEATURES

- 3-POLE FERRITE MOTOR
- DUAL BALL BEARING
- LONG LIFE POTENTIOMETER
- 3-METAL GEARS & 1-RESIN METAL GEAR
- HYBRID I.C

3. APPLICATIONS

- AIRCRAFT TO 1/4 SCALE
- 30 TO 60 SIZE HELICOPTERS
- STEERING AND THROTTLE FOR 1/10TH & 1/8TH ON-ROAD AND OFF-ROAD VEHICLES

ANNOUNCED SPECIFICATION OF HS-125MG SLIM METAL GEAR SERVO

1. TECHNICAL VALUES

CONTROL SYSTEM	:+PULSE WIDTH CONTROL 1500usec NEUTRAL	
OPERATING VOLTAGE RANGE	:4.8V TO 6.0V	
OPERATING TEMPERATURE RANGE	:-20°C TO +60°C	
TEST VOLTAGE	:AT 4.8V	AT 6.0V
OPERATING SPEED	:0.17sec/60° NO LOAD	0.13sec/60°/NO LOAD
STALL TORQUE	:3kg.cm(41.66oz.in)	3.5kg.cm(48.60oz.in)
STANDING TORQUE	:3kg.cm(41.66oz.in)	3.5kg.cm(48.60oz.in)
OPERATING ANGLE	:40°/ONE SIDE PULSE TRAVELING 400usec	
DIRECTION	:CLOCK WISE/PULSE TRAVELING 1500 TO 1900usec	
IDLE CURRENT	:7.4mA	7.7usec
RUNNING CURRENT	:180mA	230mA
DEAD BAND WIDTH	:5usec	
CONNECTOR WIRE LENGTH	:300mm(11.81in)	
DIMENSIONS	:30x10x34mm(1.18x0.39x1.33in)	
WEIGHT	:24g(0.84oz)	

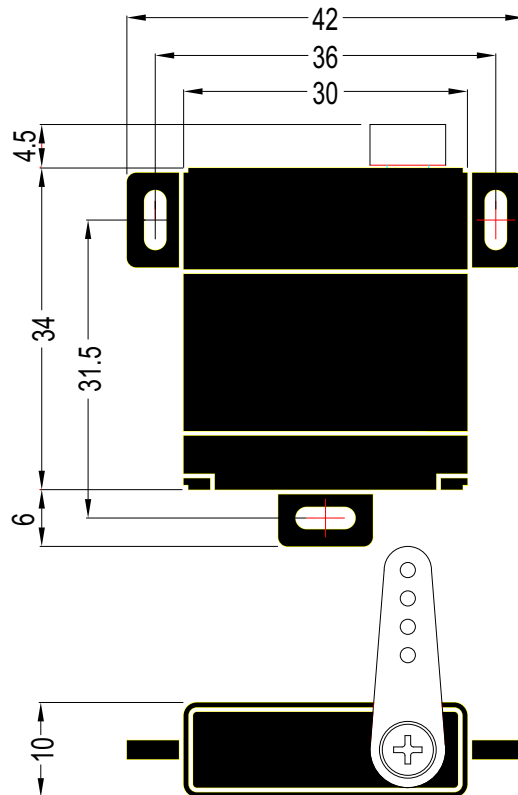

2. FEATURES

- 3 POLE CORED MOTOR
- LONG LIFE POTENTIOMETER
- GOLD PLATED CONTACTS
- SLIM SIZE
- DUAL BALL BEARING
- 4 METAL GEARS & 1 METAL RESIN GEAR

3. APPLICATIONS

- GLIDER WING

HS - 311 Standard

Detailed Specifications

Control System: +Pulse Width Control 1500usec Neutral

Required Pulse: 3-5 Volt Peak to Peak Square Wave

Operating Voltage: 4.8-6.0 Volts

Operating Temperature Range: -20 to +60 Degree C

Operating Speed (4.8V): 0.19sec/60° at no load

Operating Speed (6.0V): 0.15sec/60° at no load

Stall Torque (4.8V): 42 oz/in (3.0 kg/cm)

Stall Torque (6.0V): 49 oz/in (4.5 kg/cm)

Current Drain (4.8V): 7.4mA/idle, 160mA no load operating

Current Drain (6.0V): 7.7mA/idle, 180mA no load operating

Dead Band Width: 5usec

Operating Angle: 40° one side pulse traveling 400usec

Direction: Clockwise/Pulse Traveling 1500 to 1900usec

Motor Type: Cored Metal Brush

Potentiometer Drive: 4 Slider/Direct Drive

Bearing Type: Top/Resin Bushing

Gear Type: Nylon

360 Modifiable: [Yes](#)

Connector Wire Length: 11.81" (300mm)

Weight: 1.52oz (43g)

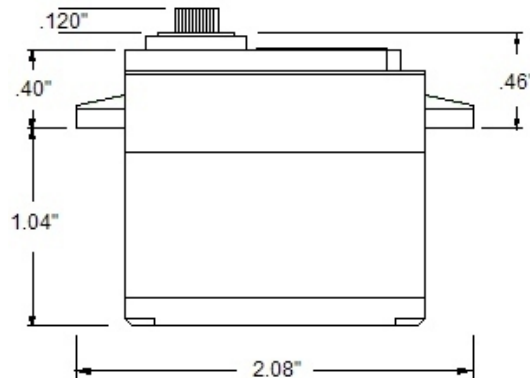
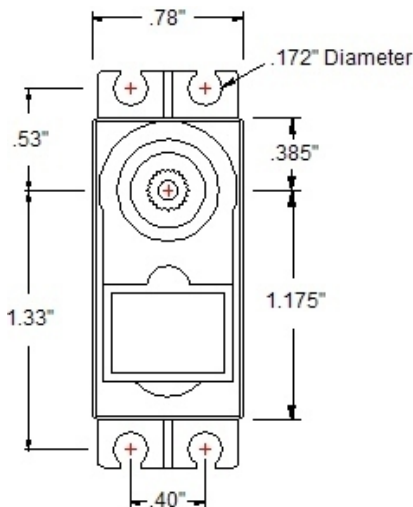
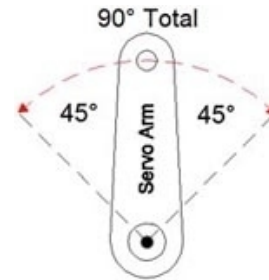

GENERAL SPECIFICATION OF HS-7955TG CORELESS DIGITAL SERVO

1. TECHNICAL VALUE

CONTROL SYSTEM	■ PULSE WIDTH CONTROL 1500usec NEUTRAL	
OPERATING VOLTAGE RANGE	■ 4.8V TO 6.0V	
OPERATING TEMPERATURE RANGE	■ -20° C TO +60° C (-68° F TO +140° F)	
TEST VOLTAGE	■ AT 4.8V	AT 6.0V
OPERATING SPEED	■ 0.19sec/60° AT NO LOAD	0.15sec/60° AT NO LOAD
STALL TORQUE	■ 18kg.cm(249.96oz.in)	24.0kg.cm(333.29oz.in)
STANDING TORQUE	■ 23.4kg.cm(324.95oz.in)/5° HOLD OUT	31.2kg.cm(433.27oz.in)/5° HOLD OUT
IDLE CURRENT	■ 9mA AT STOPPED	9mA AT STOPPED
RUNNING CURRENT	■ 220mA/NO LOAD RUNNING	300mA/NO LOAD RUNNING
STALL CURRENT	■ 3400mA	4200mA
DEAD BAND WIDTH	■ 1usec	1usec
OPERATING TRAVEL	■ 40±5° /ONE SIDE PULSE TRAVELING 400usec	
DIRECTION	■ CLOCK WISE/PULSE TRAVELING 1500 TO 1900usec	
MOTOR TYPE	■ CORELESS METAL BRUSH	
POTENTIOMETER TYPE	■ SLIDER/INDIRECT DRIVE	
AMPLIFIER TYPE	■ DIGITAL AMPLIFIER WITH MOSFET DRIVE	
DIMENSIONS	■ 40x20x37mm(1.57x0.78x1.45in)	
WEIGHT	■ 65g(2.29oz)	
BALL BEARING	■ DUAL/MR106	
GEAR MATERIAL	■ TITANIUM ALLOY	
HORN GEAR SPLINE	■ 24 SEGMENTS/φ5.76	
SPLINED HORNS	■ HEAVY DUTY/HD-IS, HD-O, HD-LS, HD-L, HD-LL	
CONNECTOR WIRE LENGTH	■ 300mm(11.81in)	
CONNECTOR WIRE STRAND COUNTER	■ 50EA	
CONNECTOR WIRE GAUGE	■ 22AWG	

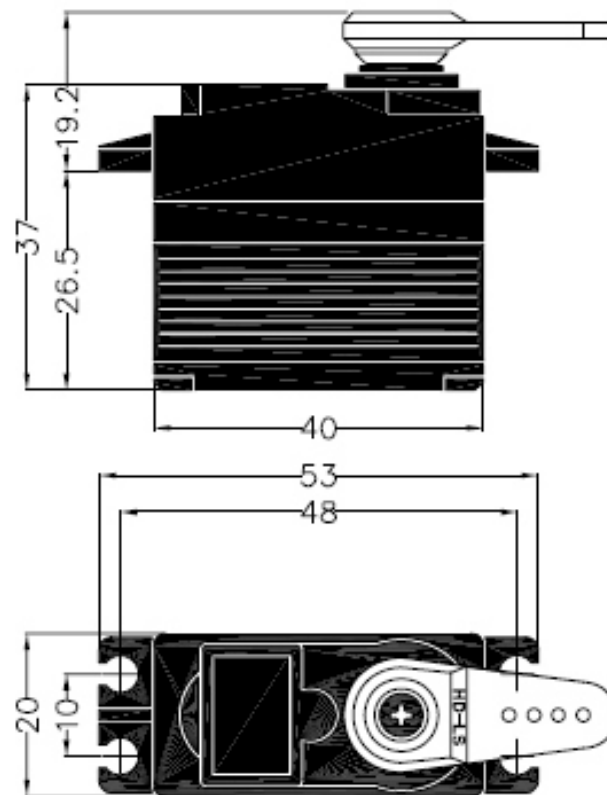

2. FEATURES

- PROGRAMMABLE DIGITAL AMPLIFIER WITH MOSFET DRIVE
- DURABLE TITANIUM ALLOY METAL GEARS WITH DUAL BALL BEARING
- ULTRA HARDNESS SHAFT WITH 3 AXIAL METAL BUSHING
- WATER & DUST TIGHT
- HEAT SINK FOR MOTOR

3. APPLICATIONS

- LARGE AIR PLANE MODELS

SS 1816 Slim servo

Product information :

Producer: Topmodel CZ
Name: Slim Servo SS1816

Item No: 0201816
Delivery status: in stock
Remark: -
Product information: Slim Servo (9 g) nylon gear.

Colour:
Super Slim Servo (9mm thick!) wih high precision and very powerfull too!



Technical specification:

Torque: 1,8 kg.cm
Speed 60°: 0,16"
Speed 40°: 0,11"
Weight: 9 g
Dimensions: 24x24x9 mm

